

2013 Conference on Behavior Issues Abbreviated Schedule

Thursday, October 10, 2013 – CONCURRENT PRE-CONFERENCE WORKSHOPS

	Workshop #1	Workshop #2	Workshop #3
9:00-12:00	Tips, Tools and Techniques: Helping with Classroom Management Richard Van Acker BEST RM 130	Policy & Legal Challenges in Meeting the Behavioral Needs of Students Carl Smith BEST RM 125	Learn, Execute and Succeed: Address Mental Health Issues Patricia A. Lowe BEST RM 135
12:00	Lunch Provided to Workshop Participants - BEST Conference Center		

Thursday, October 10, 2013 at 1:00 p.m. – CONFERENCE BEGINS

	Keynote #1			
1:00-2:30	The Importance of Systematic Screening for Behavior Kathleen Lynne Lane BEST Conference Center			
2:30- 2:45	Break			
Set I – Breakout	Topic A (Not Repeated)	Topic B	Topic C	Topic D
2:45-3:45	A Discussion & Interaction Session Kathleen Lynne Lane BEST Conference Center	Court Decisions Related to Challenging Behavior Mark Ward BEST RM 130	Can Communication Really Help Improve Behavior? Bashinski & Eicher BEST RM 125	Parent & Professional Partnerships Cokethea Hill BEST RM 135
3:45-4:00	Break with refreshments			
Set II - Breakout	Topic B	Topic C	Topic D	Topic E (Repeated Friday Set IV)
4:00 – 5:00	Court Decisions Related to Challenging Behavior Mark Ward BEST RM 130	Can Communication Really Help Improve Behavior? Bashinski & Eicher BEST RM 125	Parent & Professional Partnerships Cokethea Hill BEST RM 135	Improving School Climate & Culture Linda Geier BEST Conference Center
6:00 – 9:30	<p>"A Night on the Town" Shuttle at 6:00 p.m. from hotel to Town Cent Plaza 119th & Nail Avenue. 7:30 meet at Ya Ya's European Bistro – Southwest corner of 119th & Roe for social hour. Return transportation provided from Town Center at 9:00 and Ya Yas at 9:15 p.m.</p>			

Friday, October 11, 2013 – CONFERENCE CONTINUES

	Keynote #2			
7:45-8:15	Continental Breakfast BEST Conference Center			
8:15-9:30	Creating Safe & Healthy Schools Jeffrey Sprague BEST Conference Center			
9:30-9:45	Break			
Set III -	Topic F (Not Repeated)	Topic G	Topic H	Topic I
9:45-10:45	A Discussion & Interaction Session Jeffrey Sprague BEST Conference Center	Developing Consistent School-wide System to Address Behavior Bigby & Scarbrough BEST RM 135	Stool Has Three Legs: Providing Support for Teachers Teagarden & CRCT BEST RM 130	Professional Development that STICKS Linus & Wills BEST RM 125
10:45-11:00	Break			
Set IV -	Topic E	Topic G	Topic H	Topic I
11:00-12:00	Improving School Climate & Culture Linda Geier BEST Conference Center	Developing Consistent School-wide System to Address Behavior Bigby & Scarbrough BEST RM 135	Stool Has Three Legs: Providing Support for Teachers Teagarden & CRCT BEST RM 130	Professional Development that STICKS Linus & Wills BEST RM 125
12:00	Lunch Provided to all Conference Participants - BEST Conference Center			
	Panel Discussion			
12:30-2:30	Crucial Conversations: How to Talk with Teachers about Behavior Management BEST Conference Center			
2:30	Conference Adjourns			

**Wireless Internet
Connection Available
"KU Guest"**

BEST BUILDING

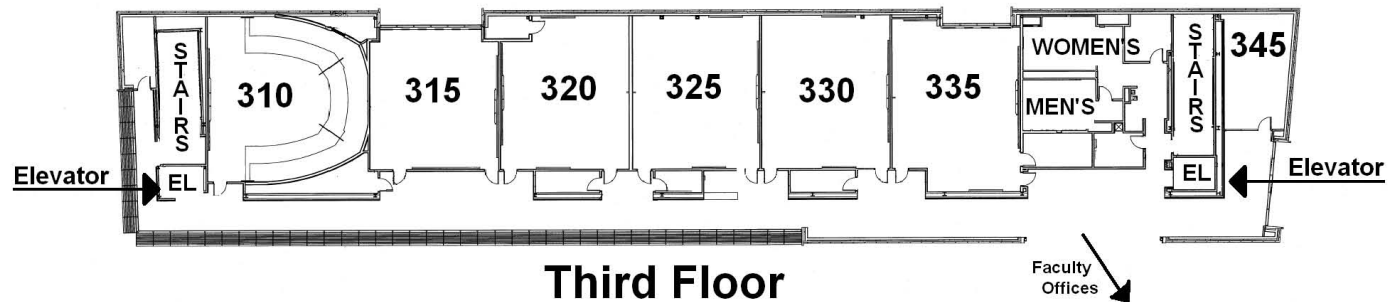
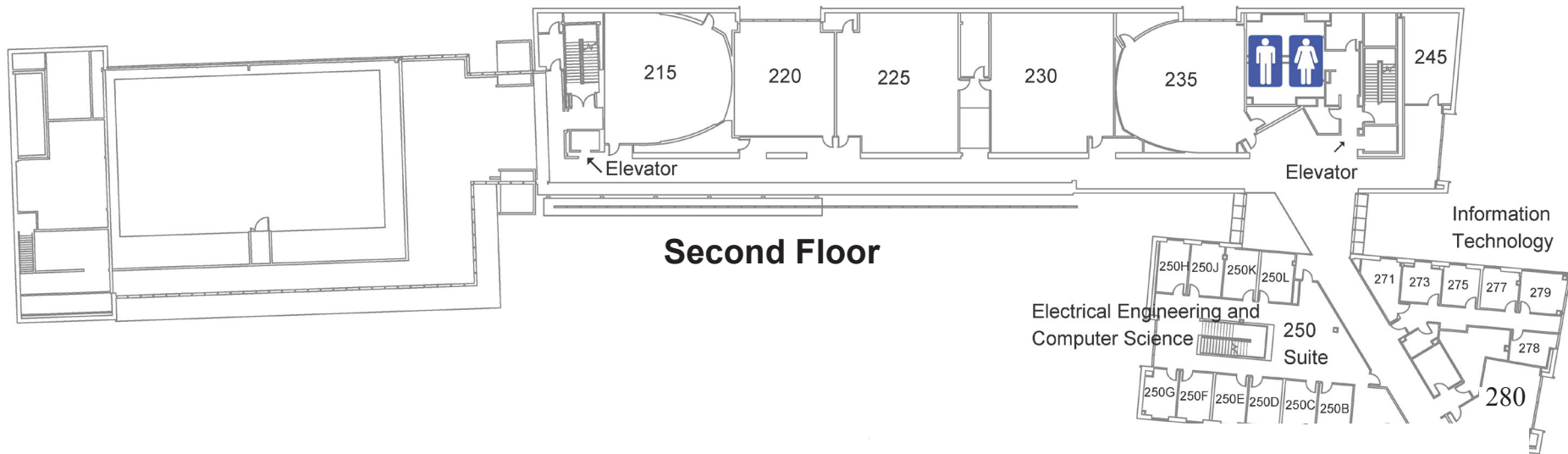
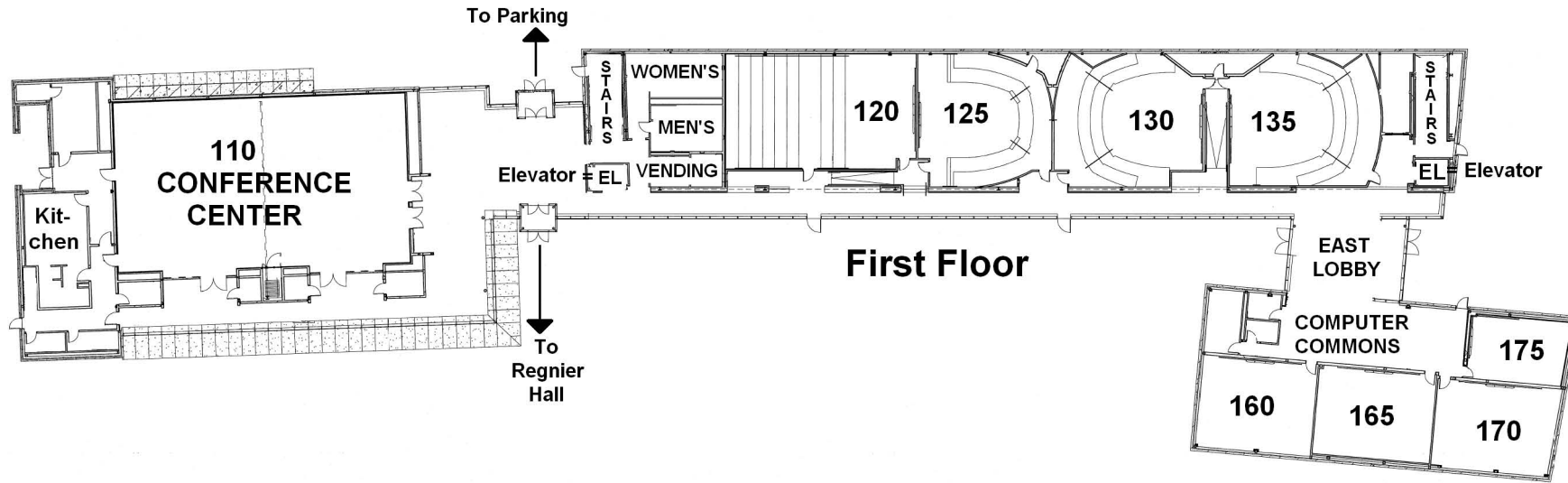



! " # \$ % & ' () * + , - & " . + (/ - 0 (!

Leadership in Behavior Disorders!

" # \$ % & ' () ! * &) + & + ! , - ' . ! / (' \$ 0 ! & ' ! , % (1) ! , \$) ' \$ % !
2 \$ 3 % 4 & % . ! 5 6 7 ! 5 8 ! 9 ! : & % ; # ! < !

Keynote Session

Friday, February 28, 2014; 8:30-10:00 a.m.

Meeting the Mental Health Needs of Students in Our Schools: Achieving Our Potential

The unmet needs of students in our schools with significant mental health conditions are receiving more widespread recognition from educators and others across this country and beyond. While some models stress the importance of bringing traditional mental health providers into the school setting, others emphasize the current potential of current resources within our schools that must not be overlooked. This keynote address will focus on emerging trends in meeting these needs.

Peter S. Jensen, M.D., President and CEO, The REACH Institute, New York, NY & Professor of Psychiatry and Vice Chair for Research Department of Psychiatry & Psychology Mayo Clinic, Rochester, MN

Mark D. Weist, Ph.D., Professor, Department of Psychology, University of SC

Moderator: **Carl R. Smith**, Ph.D. Professor, School of Education, Iowa State University, Ames, IA

Pre-Symposium Half-Day Workshops

Thursday, February 27, 2014; 9:00 a.m. – 12:00 p.m. & 1:00 – 4:00 p.m.

Nationally recognized speakers in the area of emotional behavior disorders, autism spectrum disorder, and special education present hands on practical research based sessions on Thursday morning and afternoon.

- **Proactive and Positive Approach to Classroom Management**, Randy Sprick, Safe & Civil Schools
- **Social Skills and Social Interaction Strategies for Learners with High-Functioning Autism Spectrum Disorders**, Richard Simpson & Ellen McGinnis-Smith
- **Interconnecting Systems of Positive Behavioral Interventions and Support and School Mental Health**, Mark D. Weist
- **Meeting the Academic Needs of Students With and At-risk for E/BD: A Look at Reading and Writing Interventions**, Kathleen Lane, Wendy Oakes, Robin Ennis
- **Lights, Camera, Action: Using Video Modeling to Improve Student**, Stephen Crutchfield & Rose Mason
- **Implementing Multi-Tiered Systems of Support with Young Children: Where Are We? Where Are We Going? How Can We Get There?** Judith Carta
- **HOCUS FOCUS: Working Magic in the Classroom**, Kevin Spencer, world-renowned illusionist
- **Implementing Self-management to Improve Behavior and Academic Outcomes: High and Low Tech Strategies**, Howard Wills & Richard Young

Breakout Sessions

Friday, February 28, 2014 10:20 – 11:20 a.m.; 11:30 a.m. – 12:30 p.m., 2:00 – 3:00 p.m. ; 3:15 – 4:15 p.m.
Over 30 Breakout Sessions covering a wide variety of topics

Poster Session

Friday, February 28, 2014 4:15 – 6:00 p.m.
Over 20 Posters presented covering various topics at this two-hour session.
Cash bar and complimentary hors d'oeuvres

Special Two-Hour Sessions

Saturday, March 1, 2014; 9:00 – 11:15 a.m.

- **Legal Developments in the Education of Students with EBD: What you need to know!** Mitchell Yell, Carl Smith, and Antonis Katsiyannis
- **Bullying Intervention and Positive Behavior Supports: Exploring the Intersection,** Chad Rose
- **Mermaid Trouble: Navigating the Sea of Adolescence and Autism,** Alyson Beytein
- **Obesity and Asthma and Headaches, Oh My! Physical Health Problems of Youth with Behavioral and Emotional Difficulties,** Timothy Nelson

Symposium Registration

Presymposium Workshop & Symposium
(Thursday, Friday, & Saturday)

Register Early and Receive a \$20 Discount!

\$140.00* / \$160.00

Symposium
(Friday & Saturday)

\$125.00* / \$145.00

Presymposium Workshop Only
(Thursday only)

\$110.00* / \$130.00

**Discounted registration rate available through January 24, 2014*

If you must cancel your registration, please notify the MSLBD Office at manager@mslbd.org, by Friday, January 24, 2014 to receive a refund less a \$35 processing fee. No refunds after January 24. Registrations may be transferred to another individual.

Hotel Reservations

Sheraton Kansas City Hotel at Crown Center, 2345 McGee Street, Kansas City, MO 64108, Phone: (816) 841-1000
Single/Double – \$139.00 + Tax Triple/Quad – \$164.00 + Tax

Make your reservation early for best selection of rooms. The “cut-off date” for the special negotiated room rate is January 31, 2014 at 5:00 p.m. Central Standard Time. Reservation requests received after the cut-off date will be based on availability at the Hotel's prevailing rates.

Parking

Indoor Parking at Sheraton Kansas City Hotel at Crown Center; Self-Parking Maximum Daily Rate \$16.00, Valet is \$21.00 per day. Cash upon departure or charges may be billed to your hotel account.

Information

Check our website for updates and added information about sessions www.MSLBD.org

Midwest Symposium, PO Box 1683, Manhattan, Kansas 66505
<http://www.MSLBD.org> <mailto:manager@mslbd.org>